

Ignition Transformer | ATN110A-1

The ATN110A-1 is an ignition transformer for burners. It is equipped with a changeover tap for switching the primary voltage between 100 and 200 Vac. A splash-proof case is available as an accessory.



Specifications

Primary voltage	Rated voltage	100/200 Vac 50/60 Hz, selectable by tap
	Allowable voltage	85 to 110% of rated voltage
Secondary voltage	Rated voltage	6,000 V
	Allowable voltage	6,000 V ± 10% (secondary opened)
	Secondary current	At 50 Hz: 21 mA. At 60 Hz: 16 mA
	Grounding method	One point grounding
Capacity	At 50 Hz: 155 VA. At 60 Hz: 120 VA	
Rated operation time	Continuous	
Recommended spark gap	2 mm	Caution: If used above the recommended values, the secondary voltage may become greater than the allowable voltage, causing the transformer to burn out.
Recommended air velocity in gap	5 m/s	
Secondary wiring length	1.5 m max. Use a neon tubing cable (JIS C3308) or a high voltage automotive cable (JIS C3405).	
Insulation resistance	50 MΩ min. between the primary winding and the grounding terminal with a 500 Vdc megger	
Dielectric voltage	1,500 Vac for 1 min or 1,800 Vac for 1 s between the primary winding and the grounding terminal	
Inductive withstand voltage	Voltage 1.5 times the rated primary voltage of 100 Vac or 200 Vac applied to the primary side for 1 minute with the secondary side open	
Allowable ambient temperature	-20 to +55 °C at 50% duty (maximum cycle of 60-minute energization and 60-minute stop or below) -20 to +40 °C (for continuous 60-minute energization or longer)	
Allowable ambient humidity	95% RH or below	
Paint color	Black, medium gloss paint	
Weight	Approx. 3.45 kg	
Mounting	4 screws	
Accessories	Grommets for conduit (2)	
Certified product	Electrical Appliances and Material Safety Act, acquisition number 61-18189	

External dimensions

(Unit: mm)

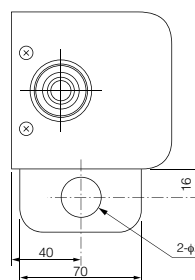

Terminal box, detailed drawing (with terminal cover removed)

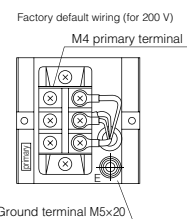

Wiring diagram

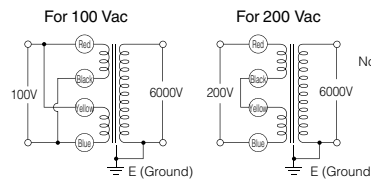

Note: When shipped, wiring configuration is for 200 V use.

Model No. configuration

Name	Model No.
Ignition transformer	ATN110A-1

Optional parts (sold separately)

Name	Model No.
Splash-proof case for ignition transformer	APN4708

1

DIGITAL CONTROLLERS

2

RECORDERS, INDICATORS

3

CONVERTERS

4

FLAME SAFEGUARD SYSTEM

5

ACTUATORS

6

SENSORS

7

GAS FLOW MEASUREMENT AND CONTROL PRODUCTS